

DESIGN
PROPOSAL

6

What is the initial approach taken in order to respond to major macro to micro scale issues in Guatemala city?

Three main interventions:

1. Urban
2. Ephemeral Architecture
3. Landscape

THE EPHEMERAL

PERMANENCY

LANDSCAPE

THE SITE

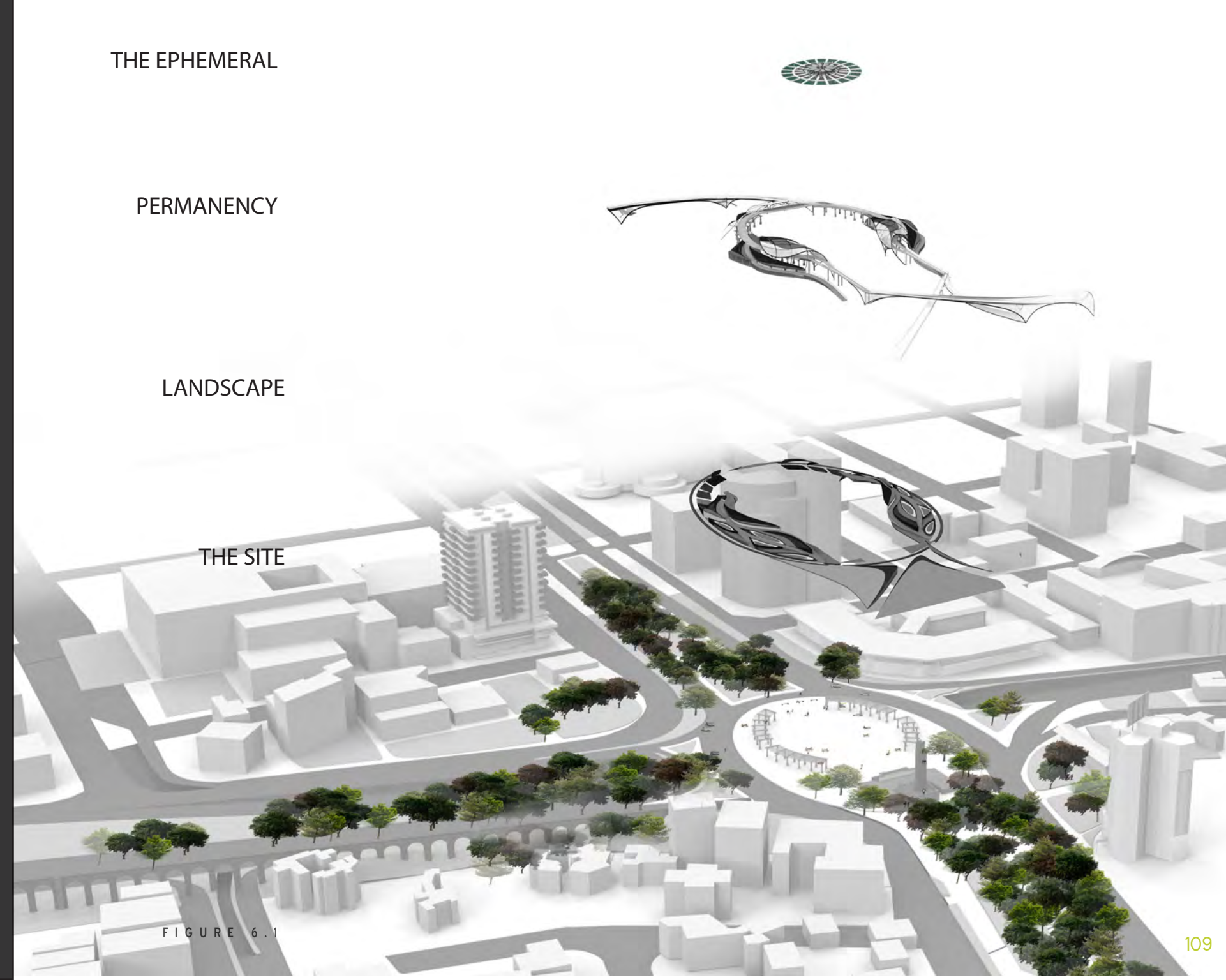

FIGURE 6.1

How is permanency achieved
through impermanency ?
&
How is impermanency achieved
through permanency ?

THE CHALLENGE

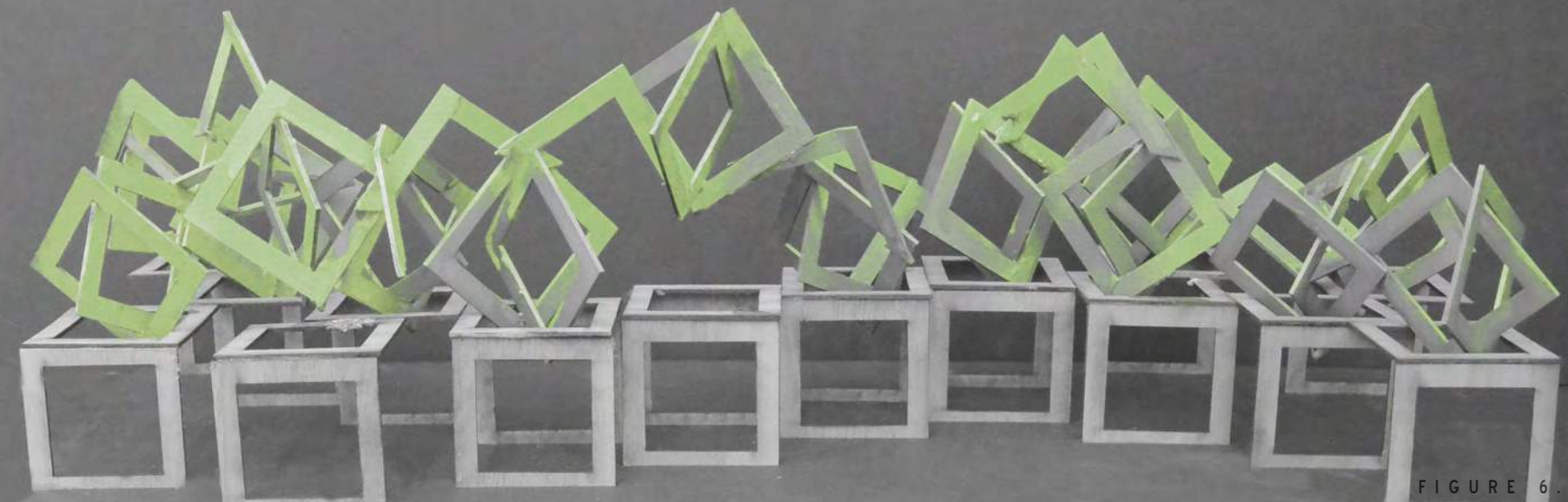

FIGURE 6.2

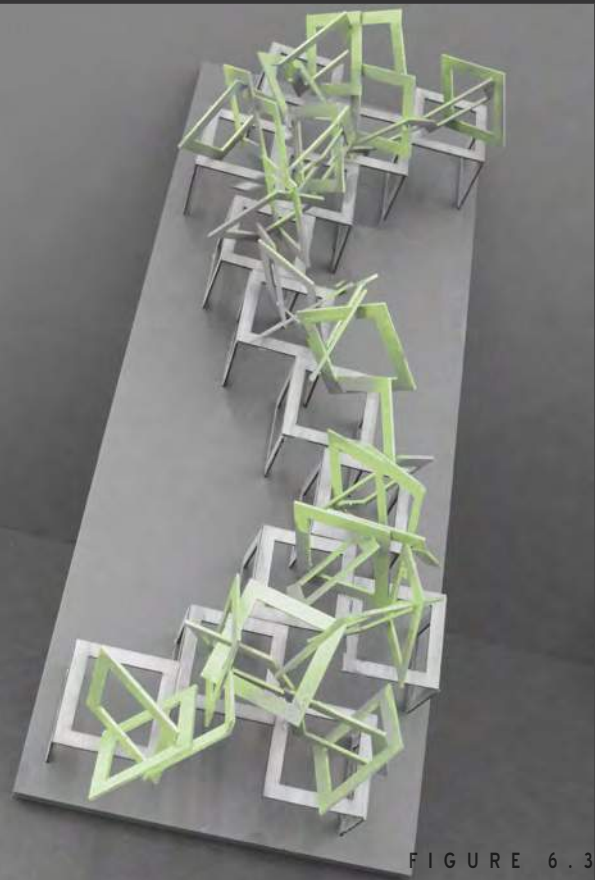

FIGURE 6.3

The following concept model seeks to explore the connection of modular shapes that shift in order to better accommodate and support another entity. This model serves to demonstrate an *attraction* between *permanency* of an object and *impermanency* of another. The interaction among objects helps *activate* and transform the static into dynamic form and movement.

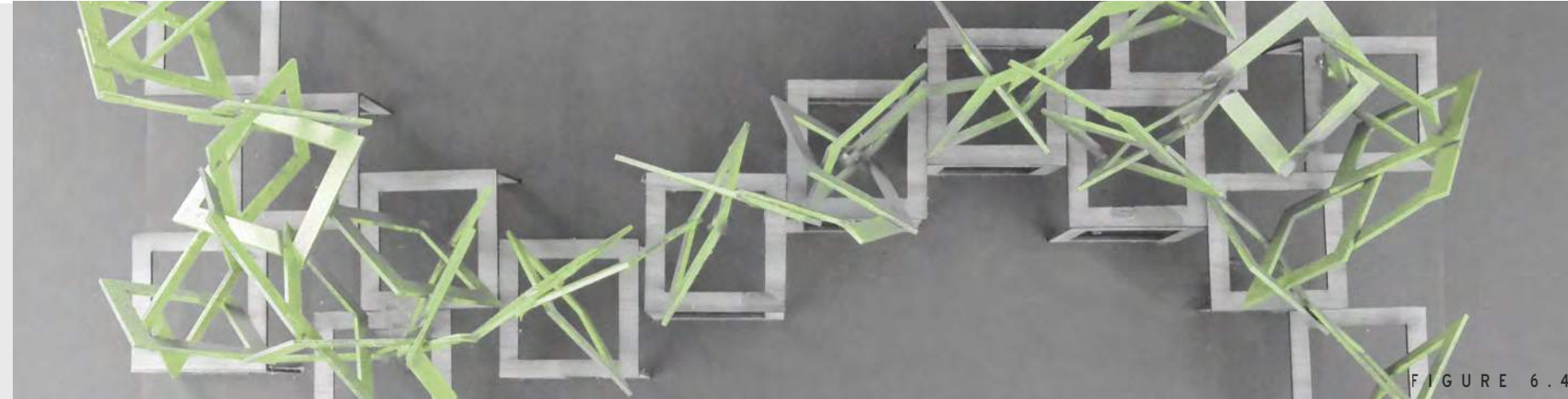

FIGURE 6.4

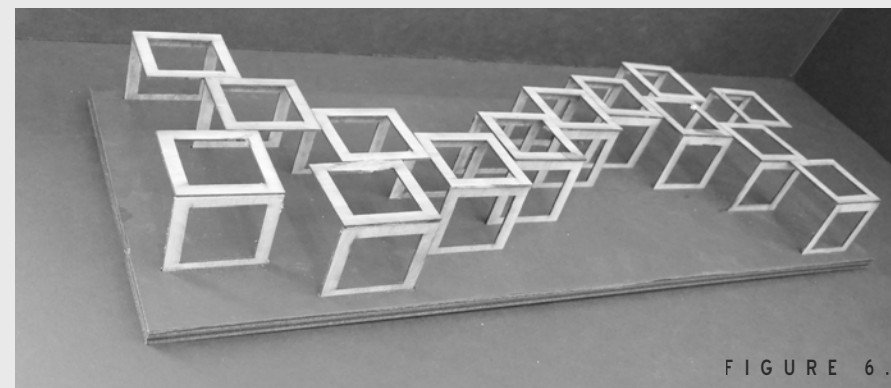

FIGURE 6.5

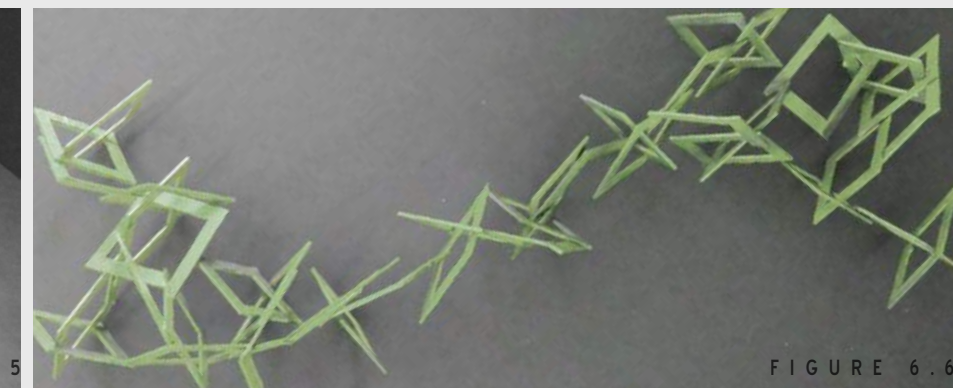
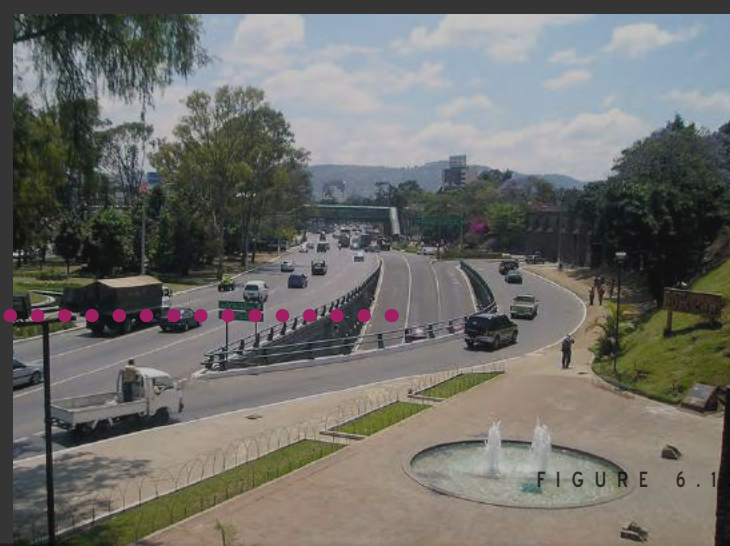
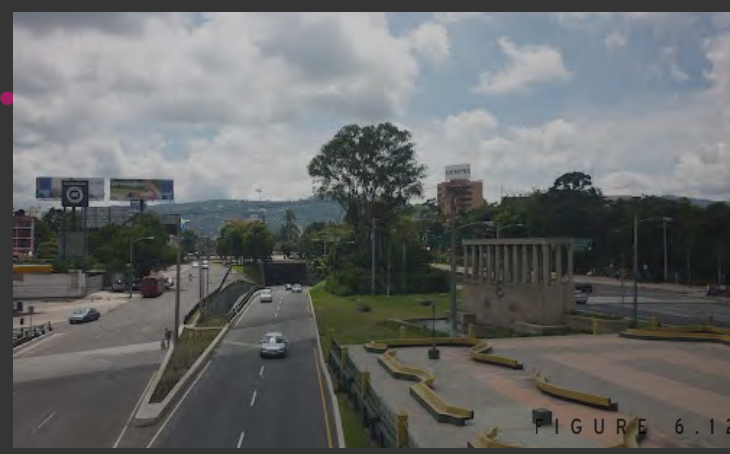

FIGURE 6.6



BULEVAR LIBERACION
FACING WEST OF SITE



FIGURE 6.14

BULEVAR LIBERACION

PERMANENCY : GRAND GESTURES THAT REMAIN

Humans and nature have great capability of dismantling, re-arranging, and essentially transforming a whole city. Nevertheless, cities are never completely abandoned or disintegrated, rather new layers are superimposed and everywhere older cities protrude into the modern fabric through change, adaptation and evolution.

The surviving structures are typically grand gestures in the form of buildings or other types of structures. Examples of such includes: monuments, arenas, stadia, religious buildings, among other landmarks. Often, one neglects that infrastructure also becomes permanent. Examples of such include: defensive city walls, roads and water supply. The names of streets and neighborhoods, too, often become permanent. These elements often remain as an imprint that continues to shape urban areas today, either because they have seen such extensive investment that it remains, or because they have been so deeply engraved into the earth that their shape remains embedded.

GUATEMALA CITY'S GRAND GESTURES

Spread around the city, grand buildings and infrastructures become the basic foot print for the superimposed master urban plan that emerges and continues to evolve over and around these permanent elements that are still or where once of great importance to the city's development.

Among this permanent infrastructures, pertaining particularly to this site, is the **"Acueducto de Pinula"**. The aqueduct was once the main source of water distribution in the city build in 1774 and completed in 1776. Today, the remaining parts of this infrastructure runs along Liberación Boulevard in Zone 9 goes through Zone 13, and ends in Zone 14. It is surrounded by underpasses, other streets, and urban landscape features. Around and through "Acueducto de Pinula" is " Zoo La Aurora", the entrance to the "Hincapie Avenue" that overlooks the "Plaza Berlin", as well leads to the Tactical Army Detachment and later the exit and entrance to La Aurora International Airport



FIGURE 6.15

6.2

IMPERMANENCY : ACTIVATION THROUGH CELEBRATION AND ANTICIPATION

Events and special occasions bring together cultural varieties of the Guatemalan population to Plaza Obelisco. Same effect tends to occur in other public areas where impermanency comes forth. Three main celebrations were carefully analyzed in order to understand successful impermanency already happening at this specific site. Each one reoccurs every year for a short period of time.

The first case study was of the event created on Independence Day. It is a nationwide celebration attracting every Guatemalan to participate in celebration of one of the most important historical events in our history. The celebration takes place at Plaza Obelisco precisely because the monument representing independence lies at this site. Another celebration of great importance occurs during the month of December. During this month we celebrate Christmas by placing a temporary Christmas tree. The tree lights up at night attracting a lot of people and temporary events that emerge all around this structure. It is space designed by the individual. Finally we study closely the urban scale temporary event occurring every Sunday. Streets through the whole boulevard close allowing people to interact with parks that are inactive during the week. As such, allowing for other events, and temporary structures to form. One that specifically activates Plaza Obelisco is the celebration of "Children's day" this event targets mainly children and their parents to the plaza. Temporary play-scapes are placed all around the site allowing a different freedom of interaction with the plaza.



FIGURE 6.16



FIGURE 6.17



FIGURE 6.18



FIGURE 6.19



FIGURE 6.20



FIGURE 6.21



FIGURE 6.22

DIA DE LA INDEPENDENCIA
INDEPENDENCE DAY [SEPTEMBER 15]



FIGURE 6.23



FIGURE 6.24



FIGURE 6.25



FIGURE 6.26



FIGURE 6.27



FIGURE 6.28



FIGURE 6.29

ARBOL NAVIDENO GALLO
CHRISTMAS HOLIDAY [DECEMBER OF EVERY YEAR]



FIGURE 6.30



FIGURE 6.31



FIGURE 6.32



FIGURE 6.33



FIGURE 6.34



FIGURE 6.35



FIGURE 6.36



FIGURE 6.37



FIGURE 6.38



FIGURE 6.39



FIGURE 6.40



FIGURE 6.41



FIGURE 6.42

“DIA DEL NINO”
CHILDREN'S DAY [OCTOBER 1ST]

6.3

[U R B A N] P R O P O S A L

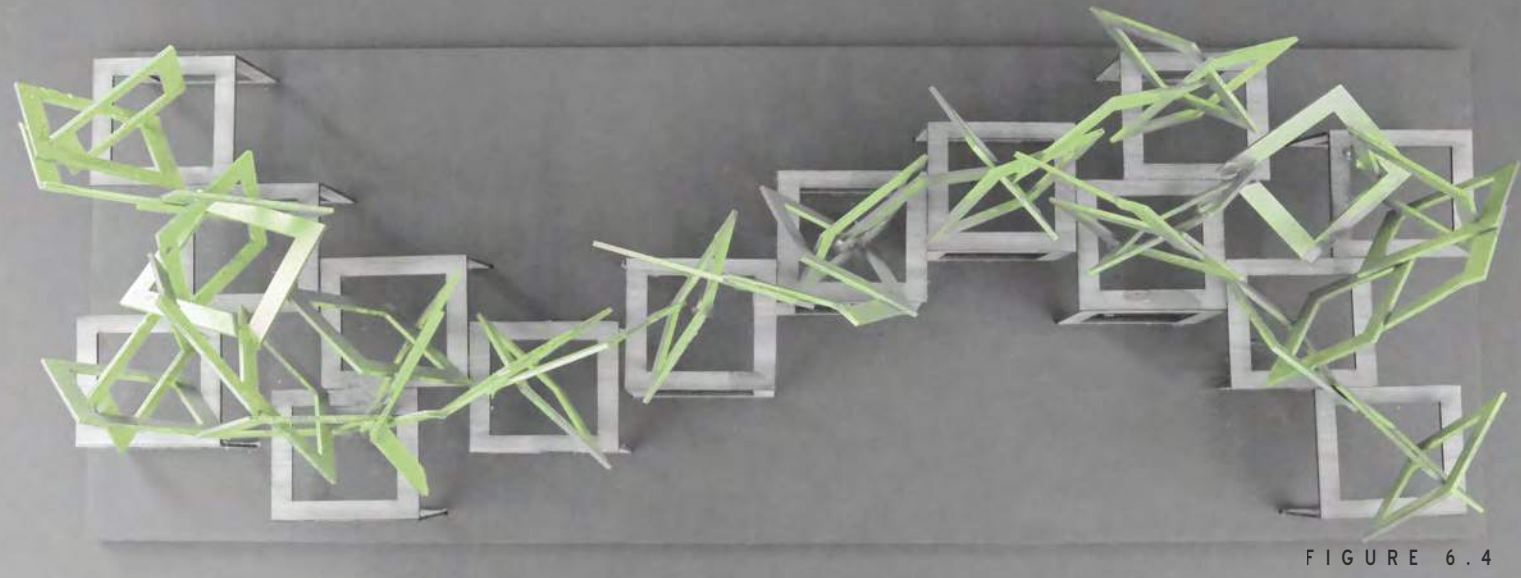

FIGURE 6.4

ACTIVATING THE EAST TO WEST AXIS

PASOS Y PEDALES [ZONE 9 & 13 MAINLY]

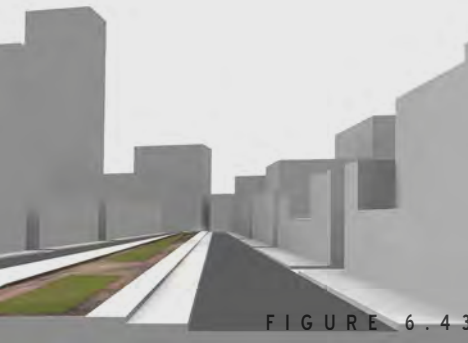

FIGURE 6.43



FIGURE 6.44



FIGURE 6.45



FIGURE 6.46

INFRASTRUCTURE VS. LANDSCAPE

CAR ACTIVITY VS. PEDESTRIAN ACTIVITY



FIGURE 6.47



FIGURE 6.48



FIGURE 6.49

ACUEDUCTO DE LA PINULA [ZONE 9, 13, & 14]

ACTIVATION, CELEBRATION, ANTICIPATION:

ACTIVATION IN NORTH TO SOUTH AXIS

The urban temporary project of Pasos y Pedales organized by the Municipalidad has and continues to demonstrate the successful result of reactivating all parks and monument roundabouts that run along the main vertical axis to which Plaza intersects.

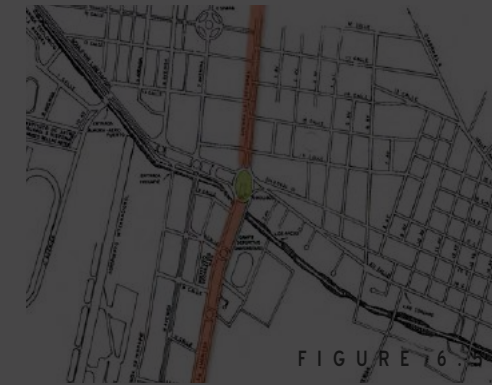

FIGURE 6

ACTIVATING THE EAST TO WEST AXIS

In order to have complete functionality of both axis the east to west needs to be activated. New projects involving bicycle routes are already helping the urban fabric to transform. It would be key to propose a bridge over and existing famous structure such as the Pinula Aqueduct in order to help activate this axis.



FIGURE 6

ACUEDUCTO DE PINULA: INFRASTRUCTURE IN RELATIONSHIP WITH PLAZA OBELISCO

IMPORTANCE, & RELEVANCE TO THE PROJECT

Earlier mentioned, one of the main permanent structures of the area is the Pinula Aqueduct, one of the first projects planned and created that helped shape and determine the master planning of the new Guatemala de la Asunción after the great earthquake of 1773. When the capital was moved due to the natural disaster occurrence, one of the main necessities and concerns to be addressed was the transportation of water to the different facilities of the capital.

It was constructed on the Mound Culebra, a rise in land held during pre-Hispanic times for the same purpose.

Since 1986 there is a ministerial agreement that protects the area of the building and its surroundings, but has failed to prevent the abandonment of these archaeological monuments.

Of great monumental value, this aqueduct once helped build Guatemala City. As such, it should be celebrated and once again be integrated to fit the necessities of modern living by helping to connect the edges of the city that neglect each other because of issues such as unfamiliarity, danger, different social classes, activities and many others.

FIGURE 6.51





FIGURE 6.52



FIGURE 6.53

ACUEDUCTO DE PINULA
BEFORE



FIGURE 6.54



FIGURE 6.55



FIGURE 6.56



FIGURE 6.57



FIGURE 6.58



FIGURE 6.59



FIGURE 6.60



FIGURE 6.61

ARCOS DEL BULEVAR LIBERACION
AFTER

A C U E D U C T + I N F R A S T R U C T U R E + P R O G R A M
“ B I C I P E D I ” B R I D G E



FIGURE 6.62

I-65 INTERCHANGE
MCEWEN DRIVE FRANKLIN, TN
WILSON & ASSOCIATES

McEwen designed a Single-Point Urban Interchange where all traffic movements are initiated at one large intersection controlled by one traffic signal, of geometric complexity. Each freeway exit and entry ramp approaches and crosses the bridge with curved alignments. Construction stakes, lines and grades were also required for sidewalk plazas that include landscape planters, colored and stamped concrete, decorative metal pedestrian railings and 19th century-style lighting fixtures.

BP BRIDGE IN
MILLENNIUM PARK OF CHICAGO
FRANK GHERY

Clad in brushed stainless steel panels, Frank Gehry's BP Bridge complements the Jay Pritzker Pavilion in function as well as design by creating an acoustic barrier from the traffic noise below. Connecting Millennium Park to Daley Bicentennial Plaza, east of the park, this 925-foot-long winding bridge, Gehry's first, provides incomparable views of the Chicago skyline, Grant Park and Lake Michigan.



FIGURE 6.65



FIGURE 6.63

THE HOVERING
GIZMODO

The Hovering provides cyclists to bike around the 72-metre diameter bridge which connects the cities of Eindhoven and Veldhoven while protecting cyclists from traffic on the Heerbaan/Meerenakkerweg intersection below.

VANCOUVER LAND BRIDGE
JONES & JONES

reconnects historic Fort Vancouver to the city's Columbia River waterfront and helps restore the natural landscape continuum from upland prairie to river edge. This pedestrian bridge, which sweeps across state route 14 in a simple, elegant arch, also commemorates the confluence of rivers and indigenous people encountered by the Lewis and Clark expedition. "The land bridge is a link back to the Klickitat Trail, Lewis and Clark and the development of the Northwest. It completes a circle that's been broken." —Johnpaul Jones



FIGURE 6.66



FIGURE 6.64

BJARKE INGELS' PUBLIC SQUARE
FOR BATTERSEA POWER STATION
BIG ARCHITECTS

The space created link the pedestrianised high street at the centre of Frank Gehry and Foster + Partner's proposal, known as Electric Boulevard, with the southern entrance of the Grade II-listed landmark, which is being revamped by Wilkinson Eyre.

TWISTED VALLEY
GRUPO ARANEA

This project aims to recover the pedestrian's traffic footprint. Since the channeling works that were made in the 70s definitely skewed Elche's Canyon continuity. For years the citizens of the city went through this place hardly enjoying it.



FIGURE 6.67

EXISTING/DEVELOPING BICYCLE ROUTE

FIGURE 6.68



FIGURE 6.69

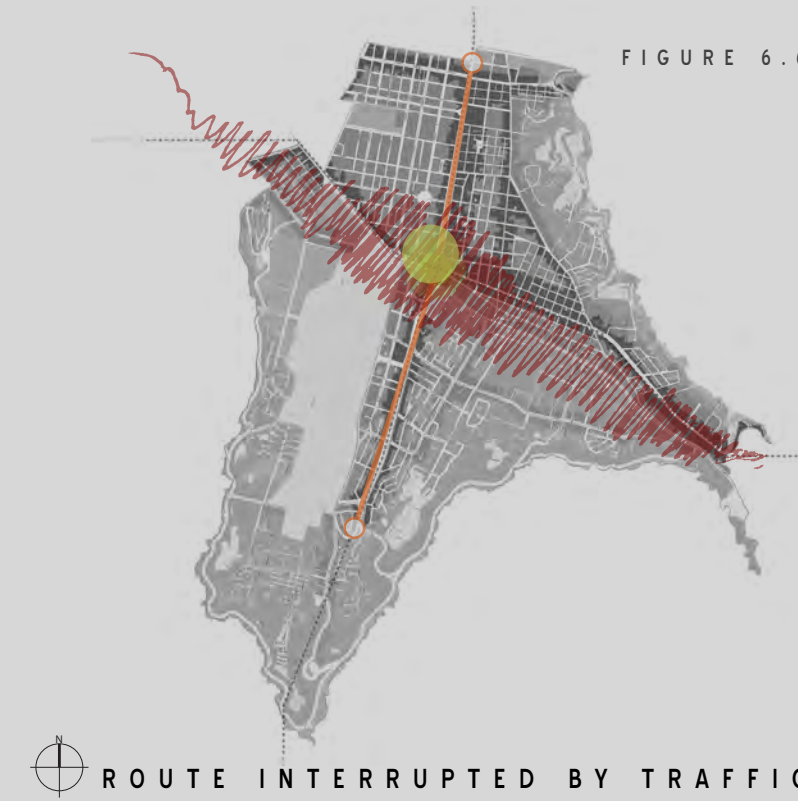

PRECEDENTS

A S K E L E T A L F R A M E W O R K
F O R E P H E M E R A L O P P O R T U N I T I E S

6.4



FIGURE 6.70



FIGURE 6.71



FIGURE 6.74



FIGURE 6.75



FIGURE 6.72



FIGURE 6.73



FIGURE 6.76

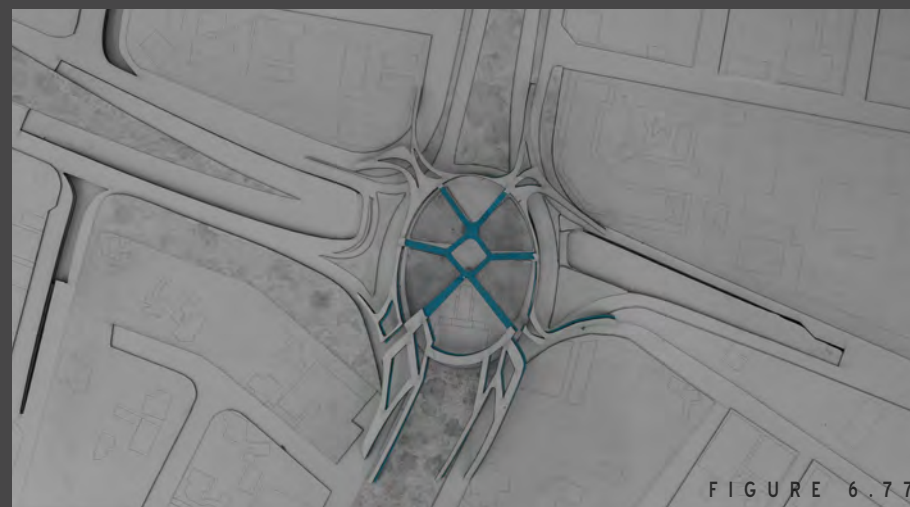

FIGURE 6.77

SCHEMATIC DESIGN

FINAL
DESIGN

7

MONUMENT + ARCHITECTURE + PROGRAM
INTERACTIVE INSTALATION

How will the new become part
of the old?
What does it mean, and why is it
important to interact over, out,
and through objects.

INTERACT, DONT DISTRACT
BECOME ONE

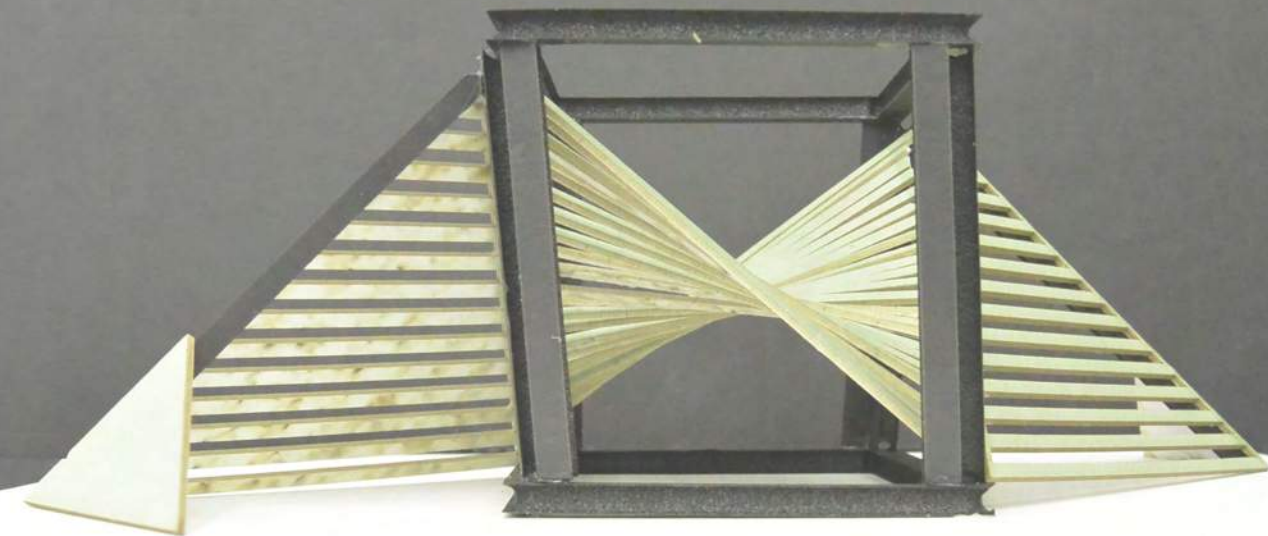

FIGURE 7.1

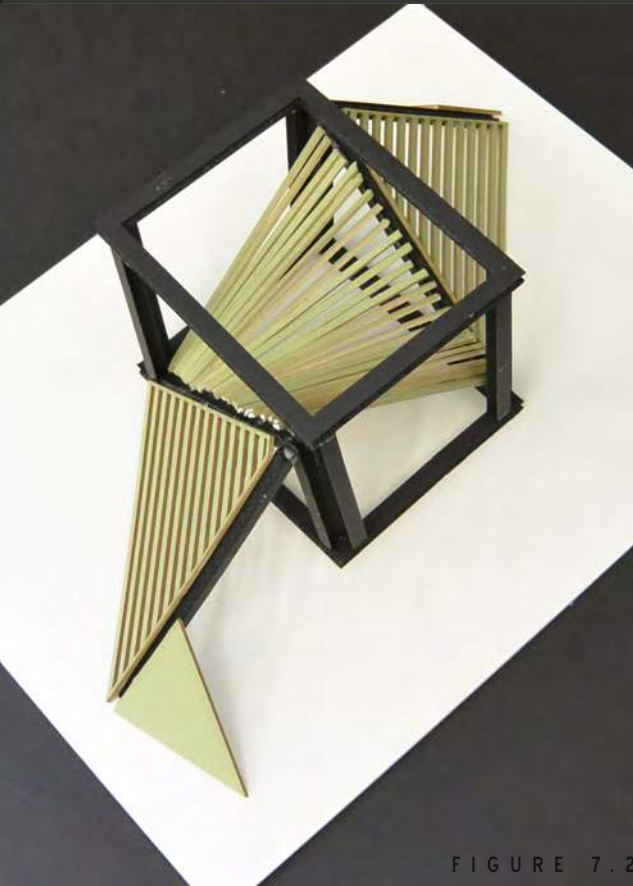

FIGURE 7.2

The following concept model seeks to explore the interaction and resulting effect of an existing static structure, represented by the black cube, with other rectilinear objects that bend and begin to adjust from the outside and through it. This model serves to demonstrate an *interaction* between *permanency* of an object and *impermanency* of another. A *static* versus an *active* and finally an *existing* and an *adapting* one. All juxtapositions demonstrate a sense of harmony and support that is achieved visually and through the new spatial qualities created by the playful combination of one objects towards another.

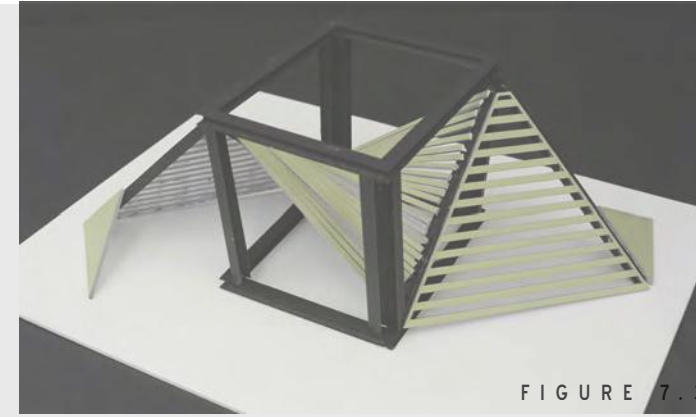

FIGURE 7.3

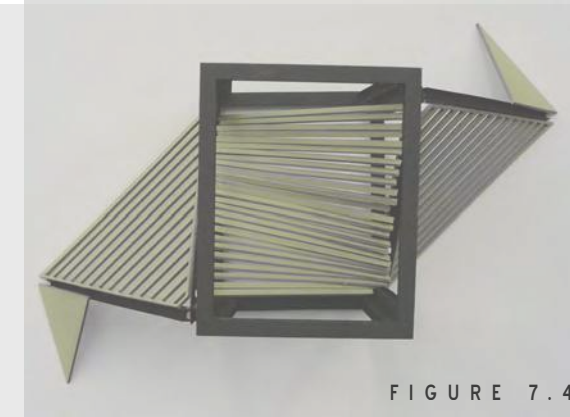

FIGURE 7.4

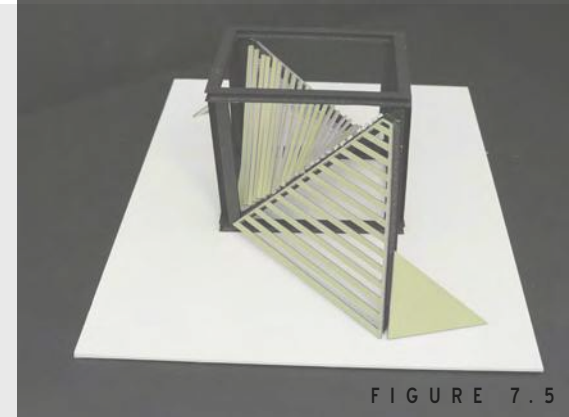

FIGURE 7.5

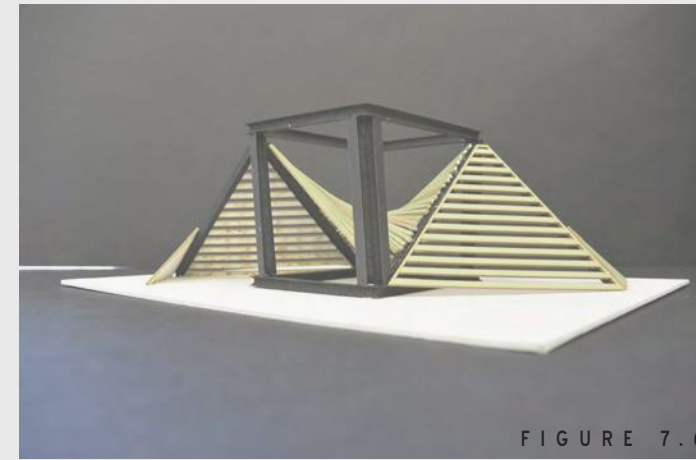

FIGURE 7.6

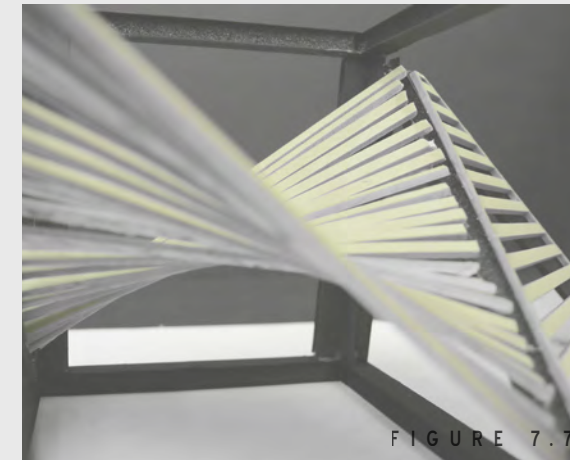

FIGURE 7.7

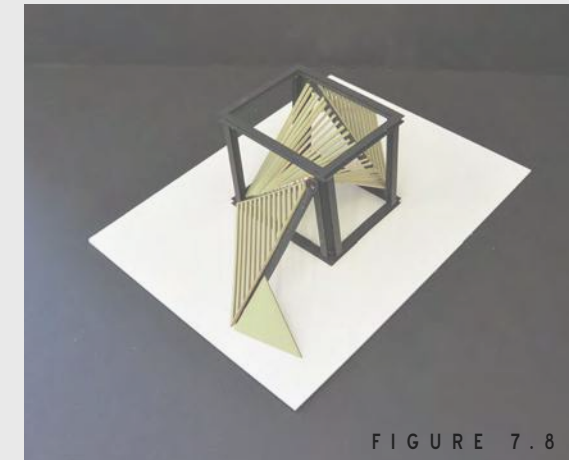

FIGURE 7.8

7.1 LANDSCAPE PROPOSAL



FIGURE 7.9

TRANSFORMING THE LAND



S I T E P L A N

FIGURE 7.10

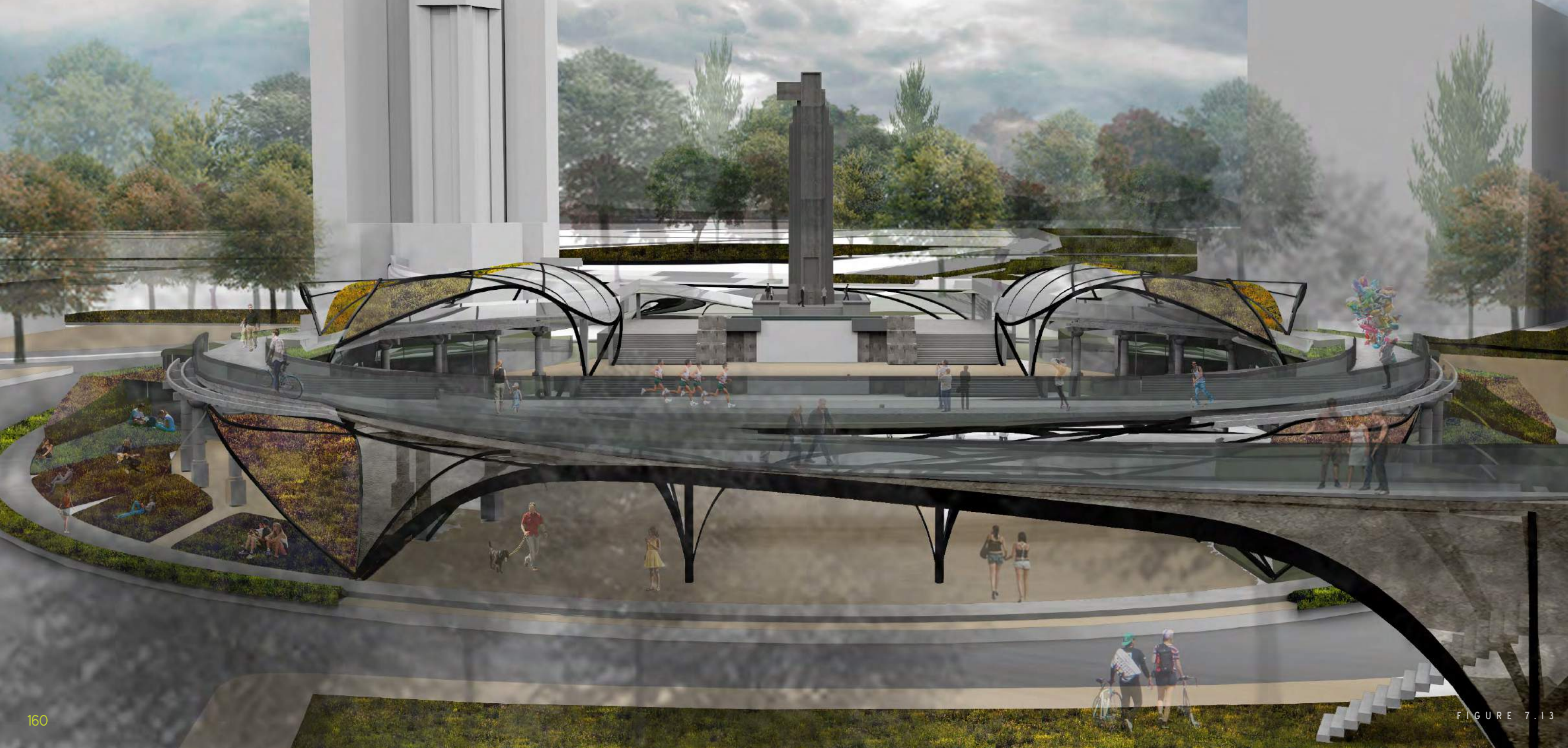

FIGURE 7.11

P E R S P E C T I V E

7.2

REACTIVATING AN EXISTING STRUCTURE



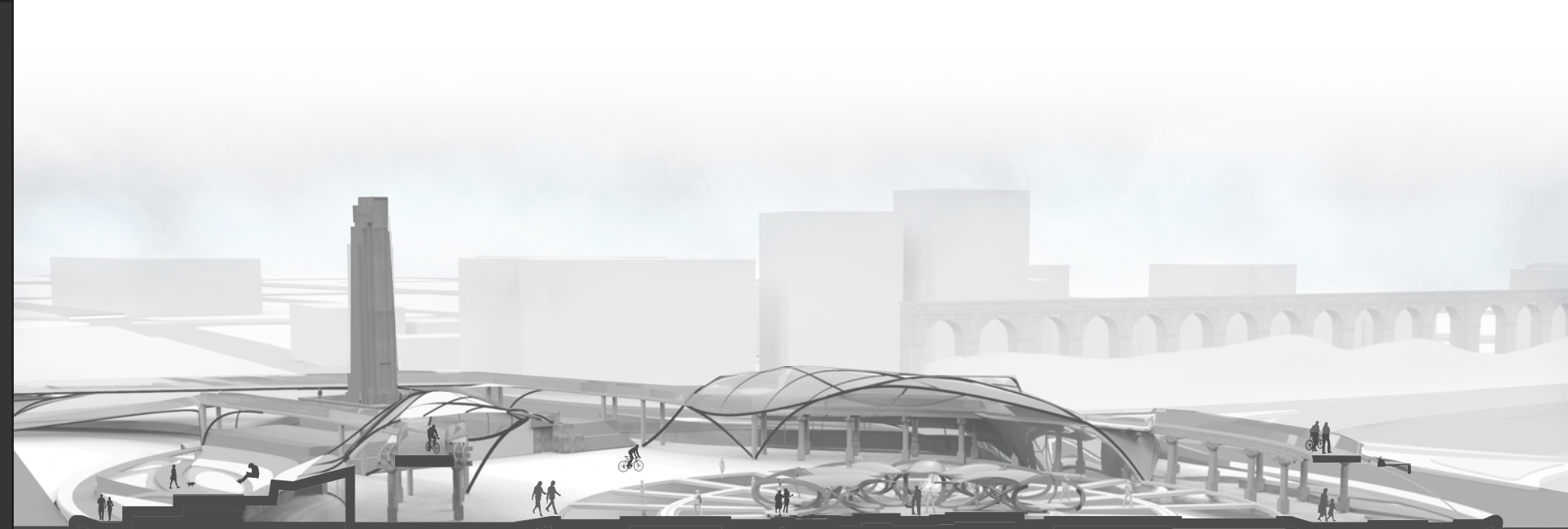

LONGITUDIINAL SECTION

FIGURE 7.14

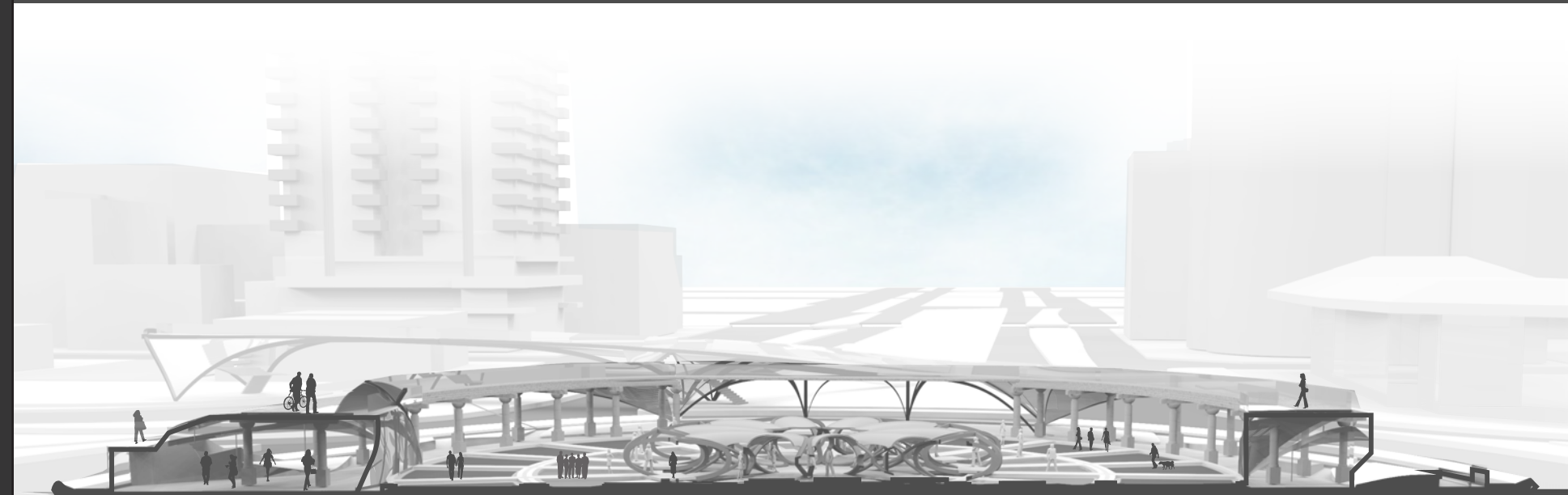

TRANSVERSE SECTION

FIGURE 7.15

SECTIONS

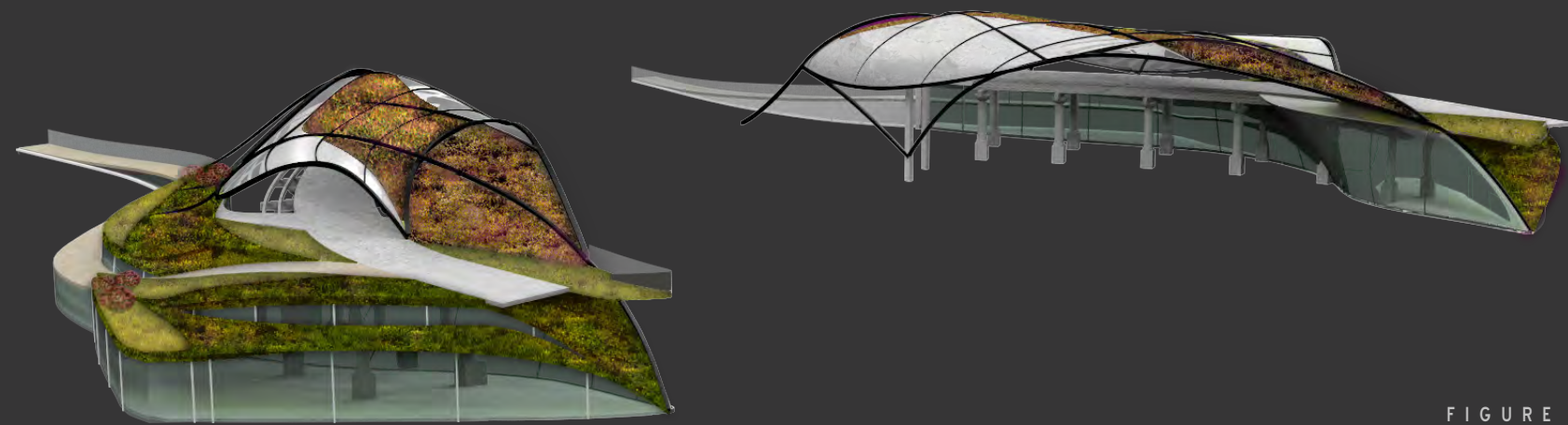

FIGURE 7.16

SERVICE BUILDING :
HIDDEN IN THE LANDSCAPE

EXPLODED AXON:
SERVICE/STORAGE BUILDING

SHADING STRUCTURE:

THIS STRUCTURE PROVIDES SHADING FOR THE PROPOSED BRIDGE. THE STRUCTURE WAS DESIGNED AND PLACED TO ACT AS A SOUND BUFFER.

THE LANDSCAPE:

THE LANDSCAPE "DRESSES" THE ARCHITECTURE DESIGNED TO INTERACT AND TRANSFORM SPACE OF THE PROPOSED AND EXISTING ARCHITECTURE.

THE BRIDGE:

THE PROPOSAL REACTIVATES AN EXISTING STRUCTURE, AT THE SAME TIME IT CREATES A CONNECTION BETWEEN THE EDGES OF THE CITY. THE BRIDGE GIVES PRECEDENCE TO THE PEDESTRIAN BY ELEVATING AND ALLOWING THEM TO BE "ABOVE" THE CITY'S CHAOTIC TRANSIT AND CIRCULATION SYSTEM.

THE BUILDING:

HIDDEN YET INTERACTING WITH IN THE LANDSCAPE, THIS PROPOSAL WAS DESIGNED TO SUPPORT AND NOT DISTRACT. THE BUILDING PROVIDES STRUCTURE FOR THE LANDSCAPE AND THE BRIDGE. PROGRAMMATICALLY, IT PROVIDES MAIN SERVICES TO THE PUBLIC AND STORAGE SPACE FOR THE PODS AND THE STANDS OF THE INSTALLATION.

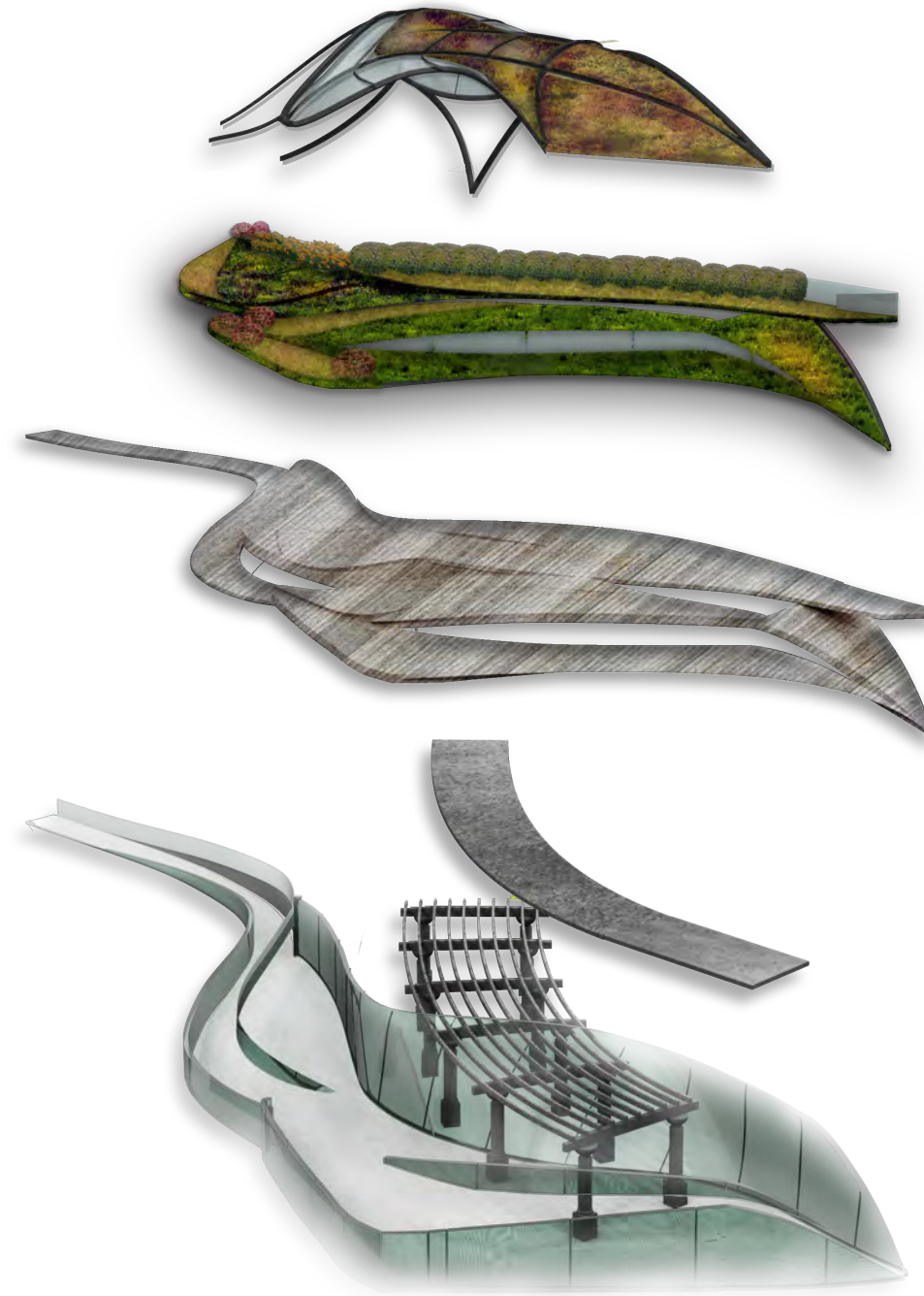

FIGURE 7.17



FIGURE 7.18

T O D A Y W I L L B U I L D T O M O R R O W

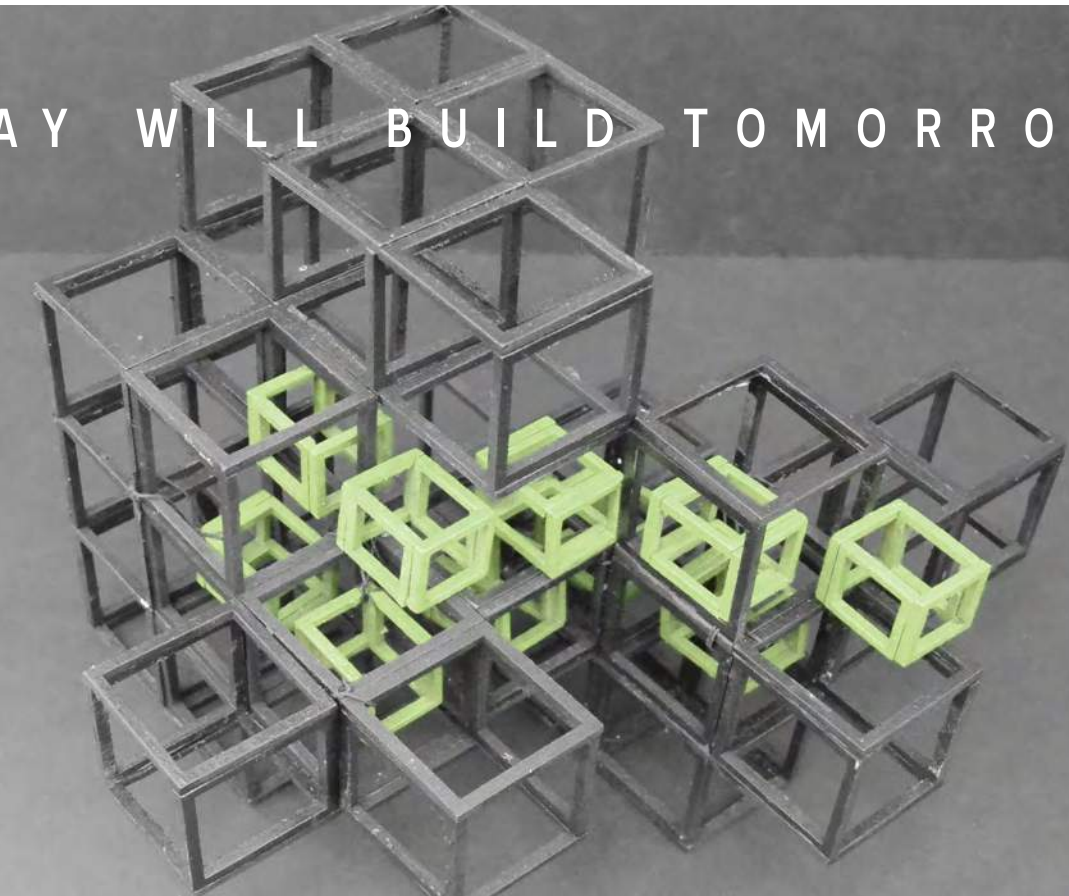

FIGURE 7.19

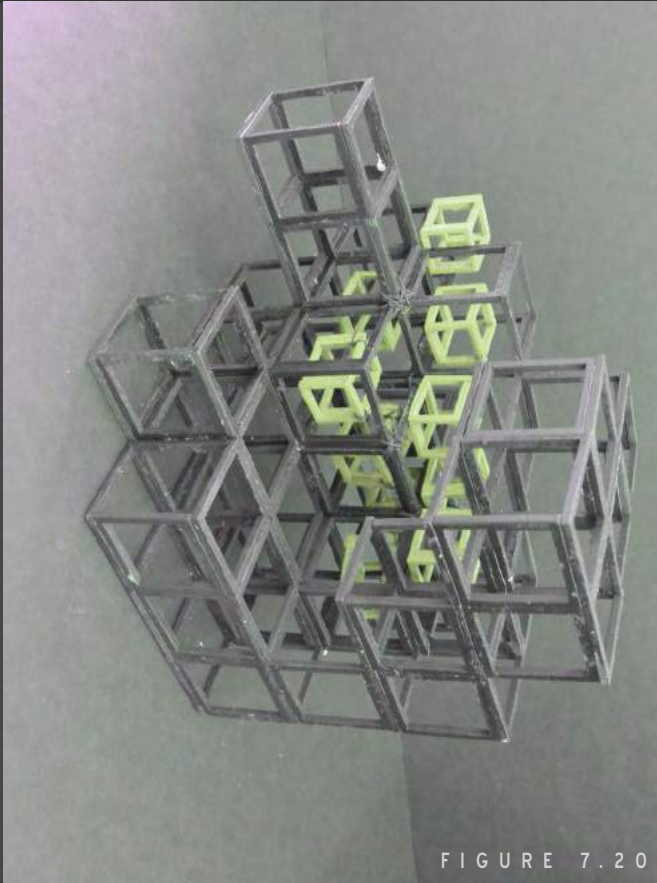

FIGURE 7.20

The following concept model seeks to explore **human scale**. It was created to study how can **modular shapes** that imitate existing ones can creating a sense of familiarity by keeping organization and rhythm. At the same time this shapes create spaces within the original spaces creating scale.

The city is vast and overwhelming such that we tend to lose the sense of human scale during the design phase. It is important to address all issues at all scale targeting all users and understanding that there are many options in design that can help accomplish the goals of a functional and successful city.



FIGURE 7.21

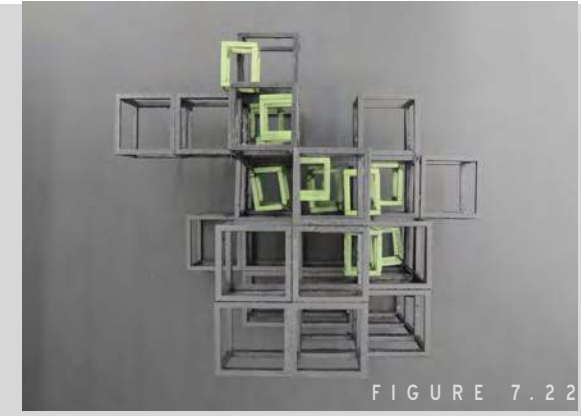

FIGURE 7.22

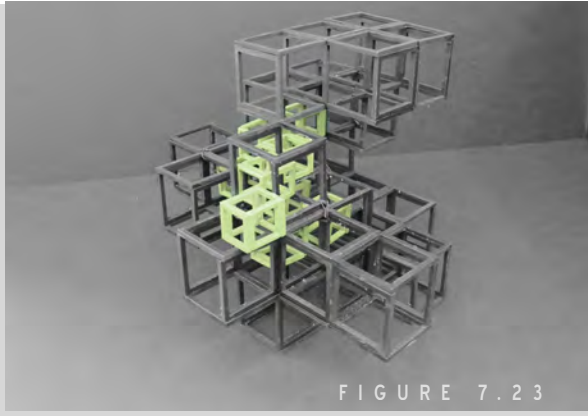

FIGURE 7.23

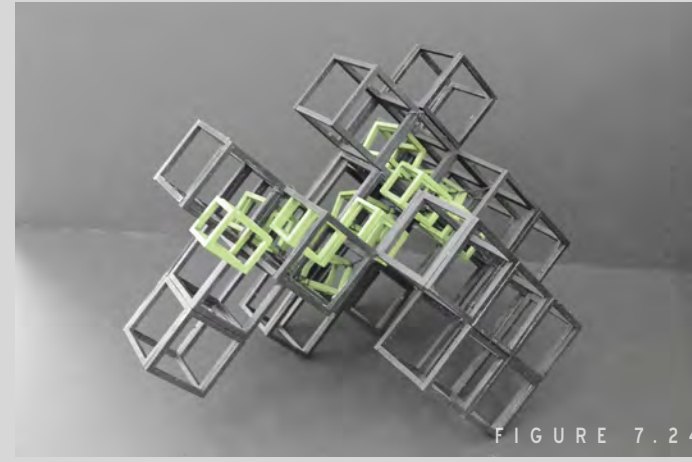

FIGURE 7.24

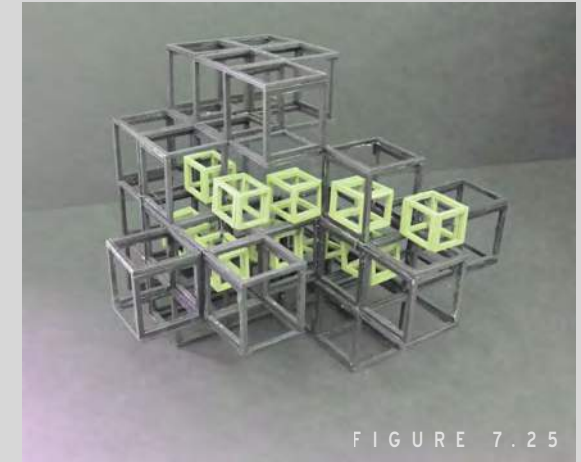

FIGURE 7.25

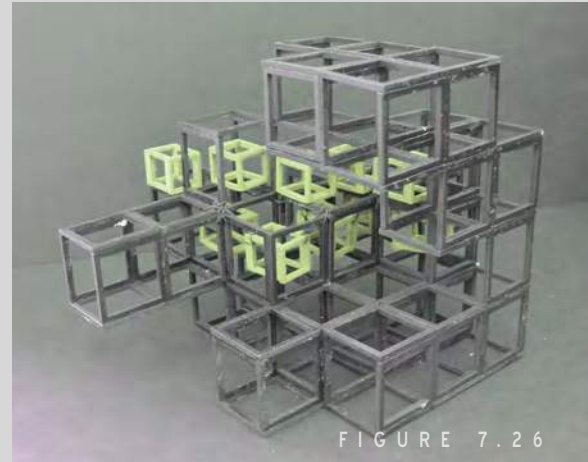

FIGURE 7.26

7.3

ACTIVATING PLAZA OBELISCO



FIG 7.27

FLEXIBILITY

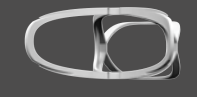
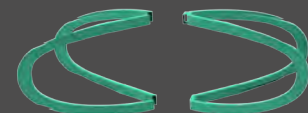
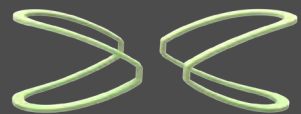

FIG 7.28

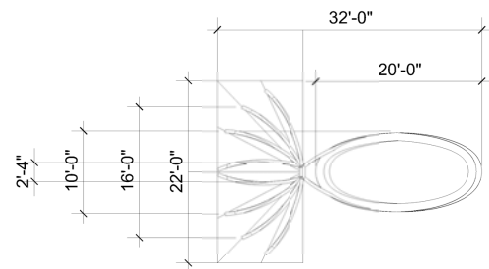

FIG 7.29

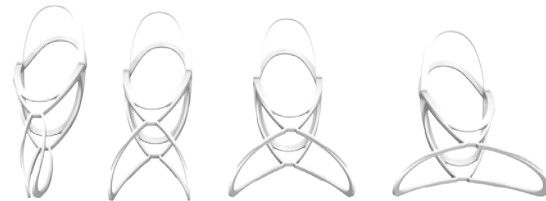

FIG 7.30

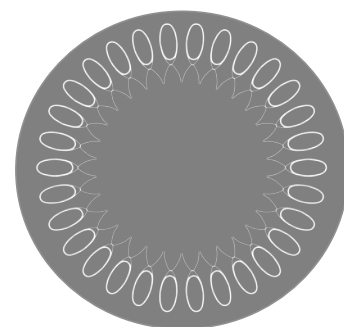

FIG 7.31

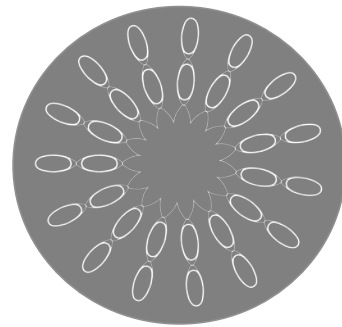

FIG 7.32

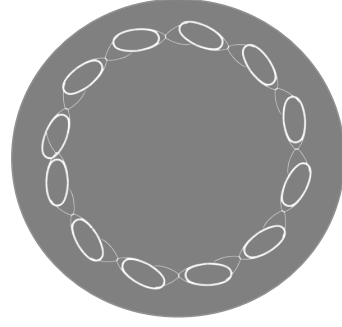

FIG 7.33

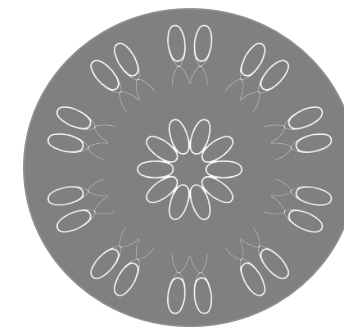

FIG 7.34

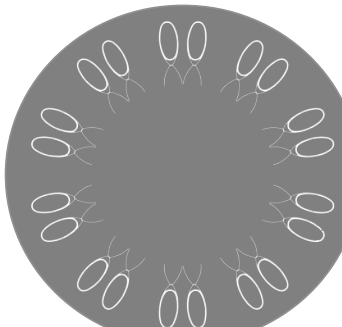

FIG 7.35

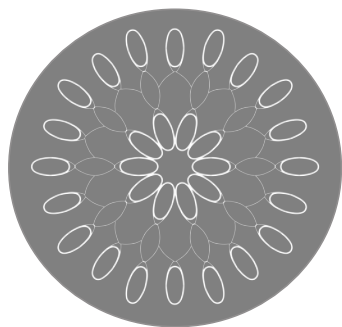
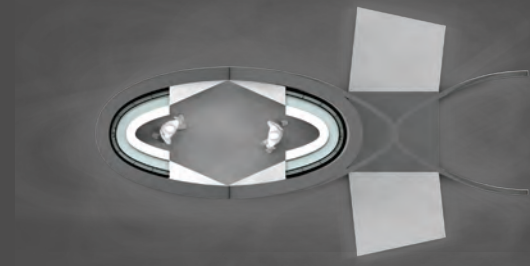
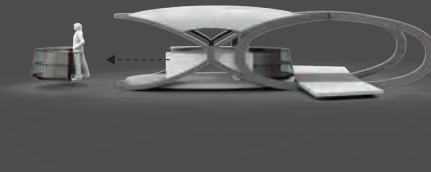
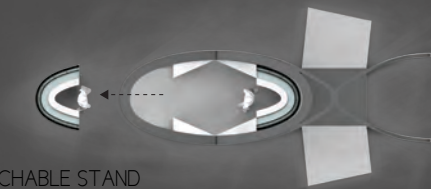

FIG 7.36



DETACHABLE STAND



ADJUSTABLE TABLE

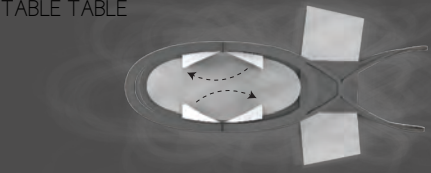

FIG 7.37



RELAX EAT EXERCISE

FIG 7.38

50% CIRCULATION



FIG 7.39

50% PROGRAM



FIG 7.40



FIG 7.41

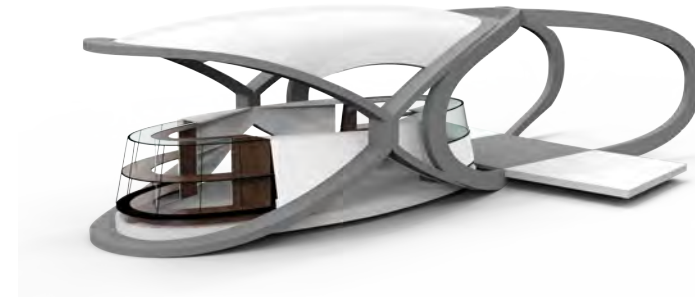
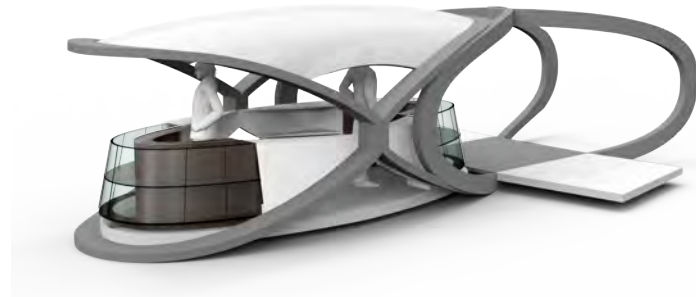

FIG 7.42

FIG 7.43



FIG 7.44

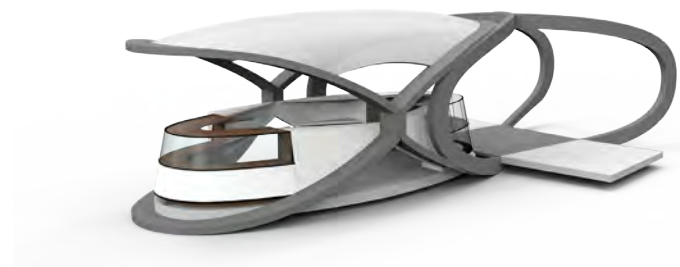

FIG 7.45

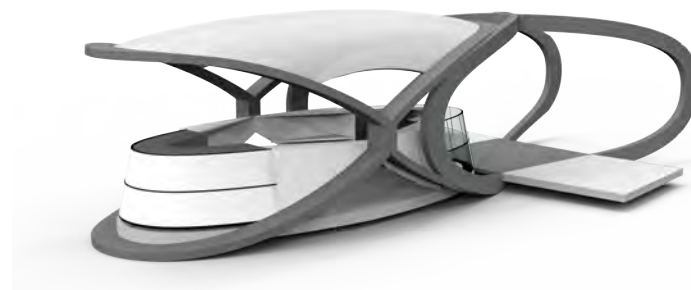



FIG 7.46

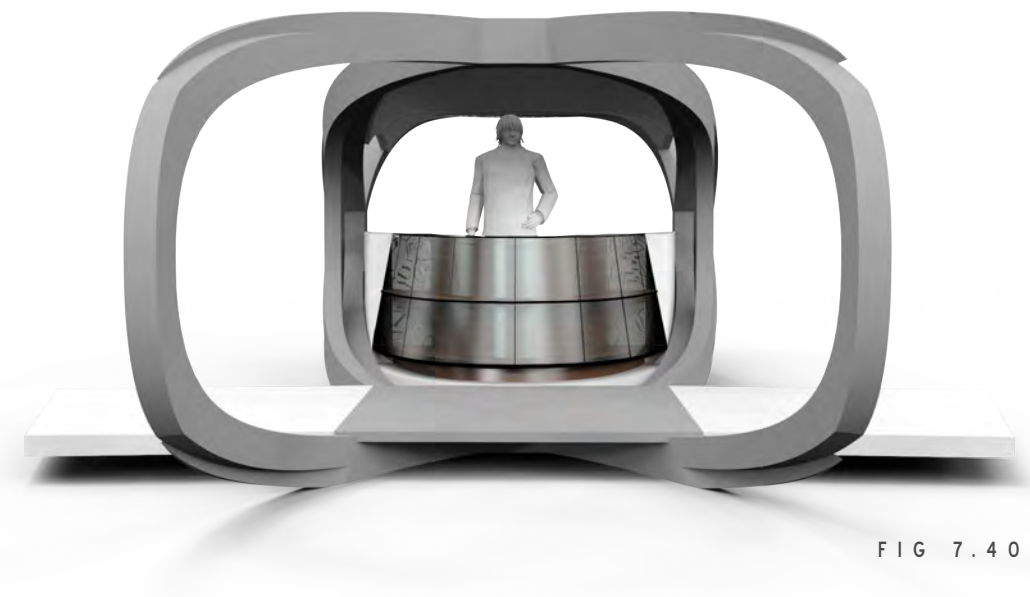
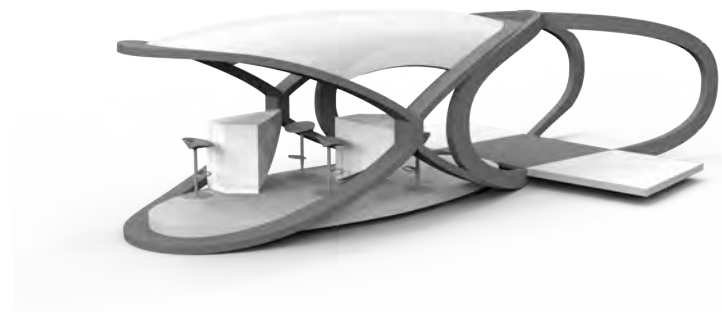

FIG 7.40

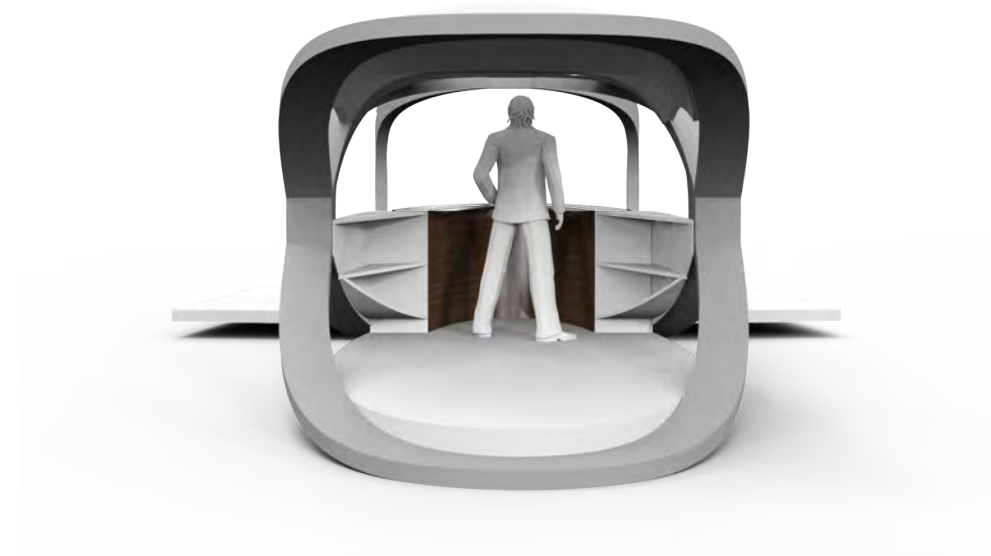
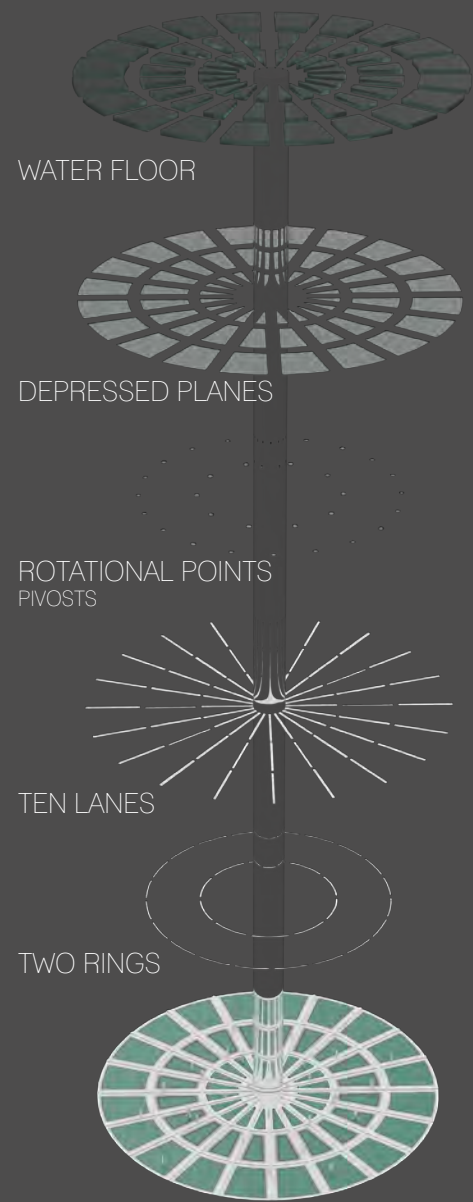

FIG 7.41

THE BASE



FIG 7.47



WATER FLOOR

DEPRESSED PLANES

ROTATIONAL POINTS
PIVOTS

TEN LANES

TWO RINGS

COMPLETE ASSEMBLY

FIG 7.48

THREE MAIN STATES

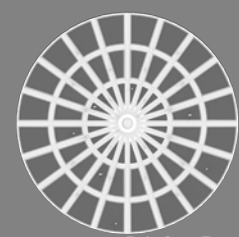

FIG 7.49

OPEN



FIG 7.50

WATER

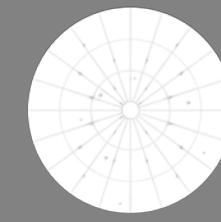

FIG 7.51

COMPLETE CLOSURE

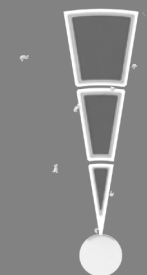

FIG 7.52



FIG 7.53

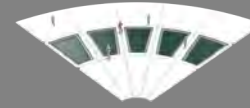

FIG 7.54

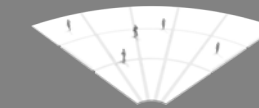

FIG 7.55

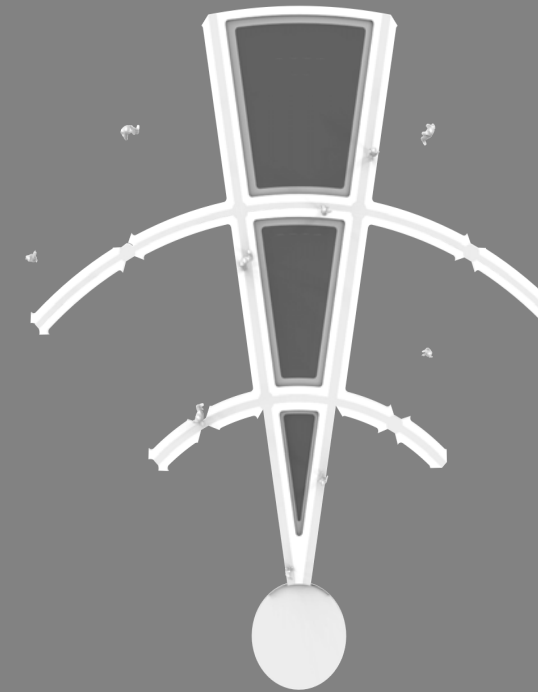

FIG 7.56

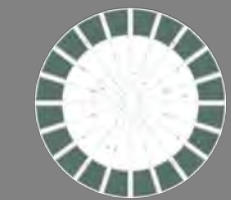

FIG 7.57



FIG 7.58



FIG 7.59

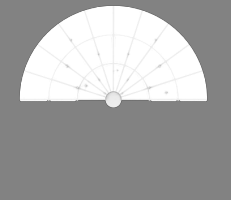

FIG 7.60

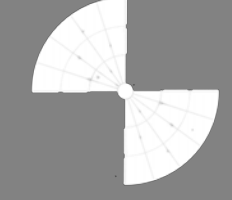

FIG 7.61



FIG 7.62



FIG 7.63

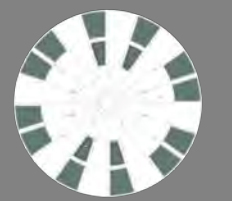

FIG 7.64

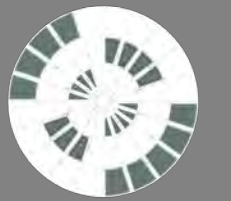

FIG 7.65

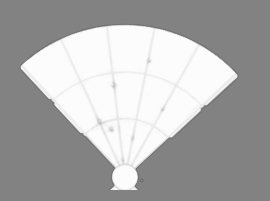

FIG 7.66

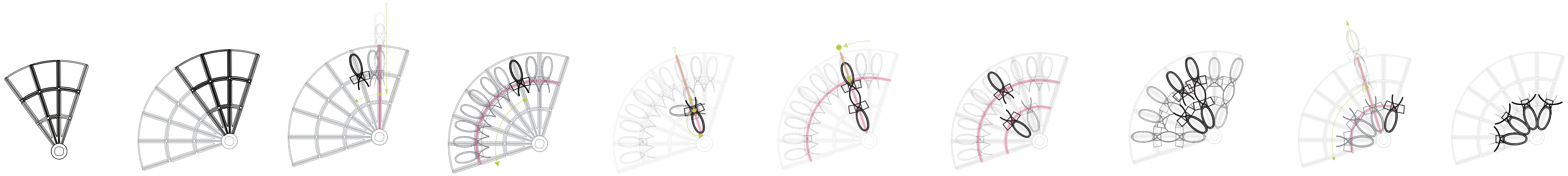

FIG 7.67

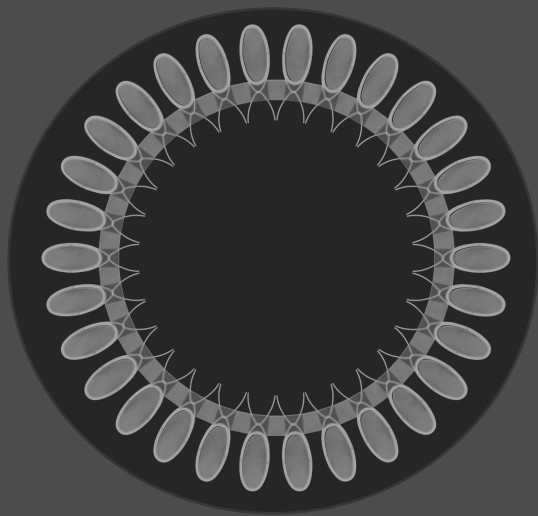

FIG 7.68

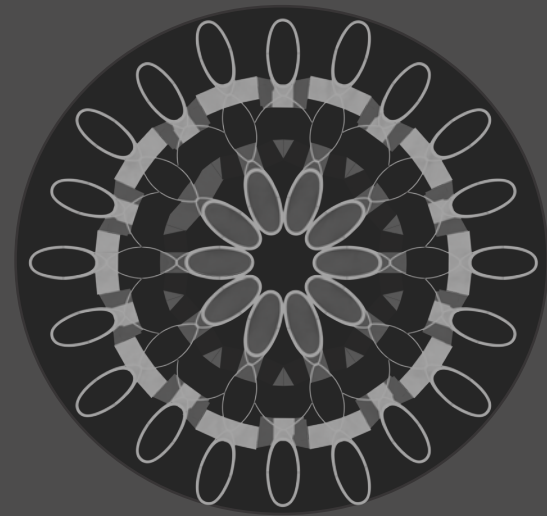

FIG 7.69

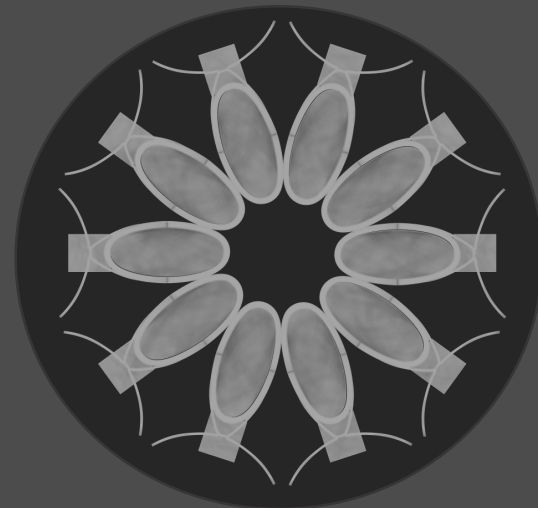

FIG 7.70

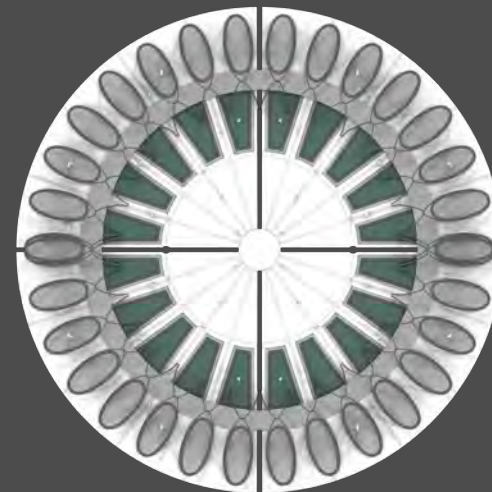

FIG 7.71

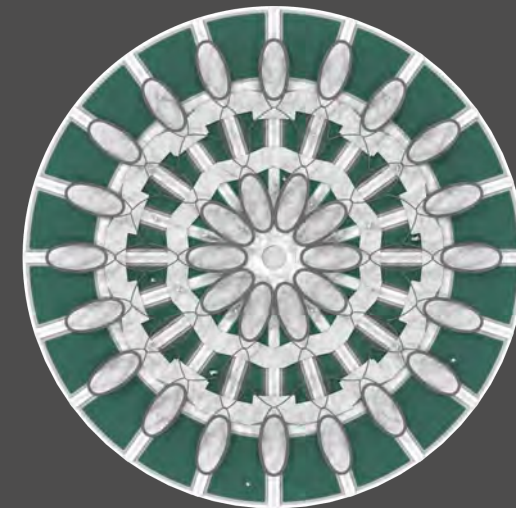

FIG 7.72

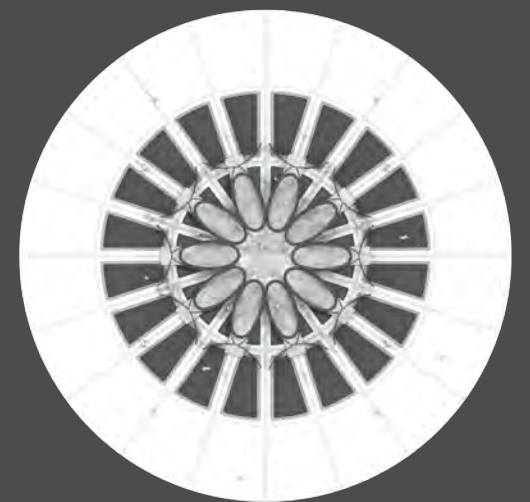

FIG 7.73





FIG 7.74

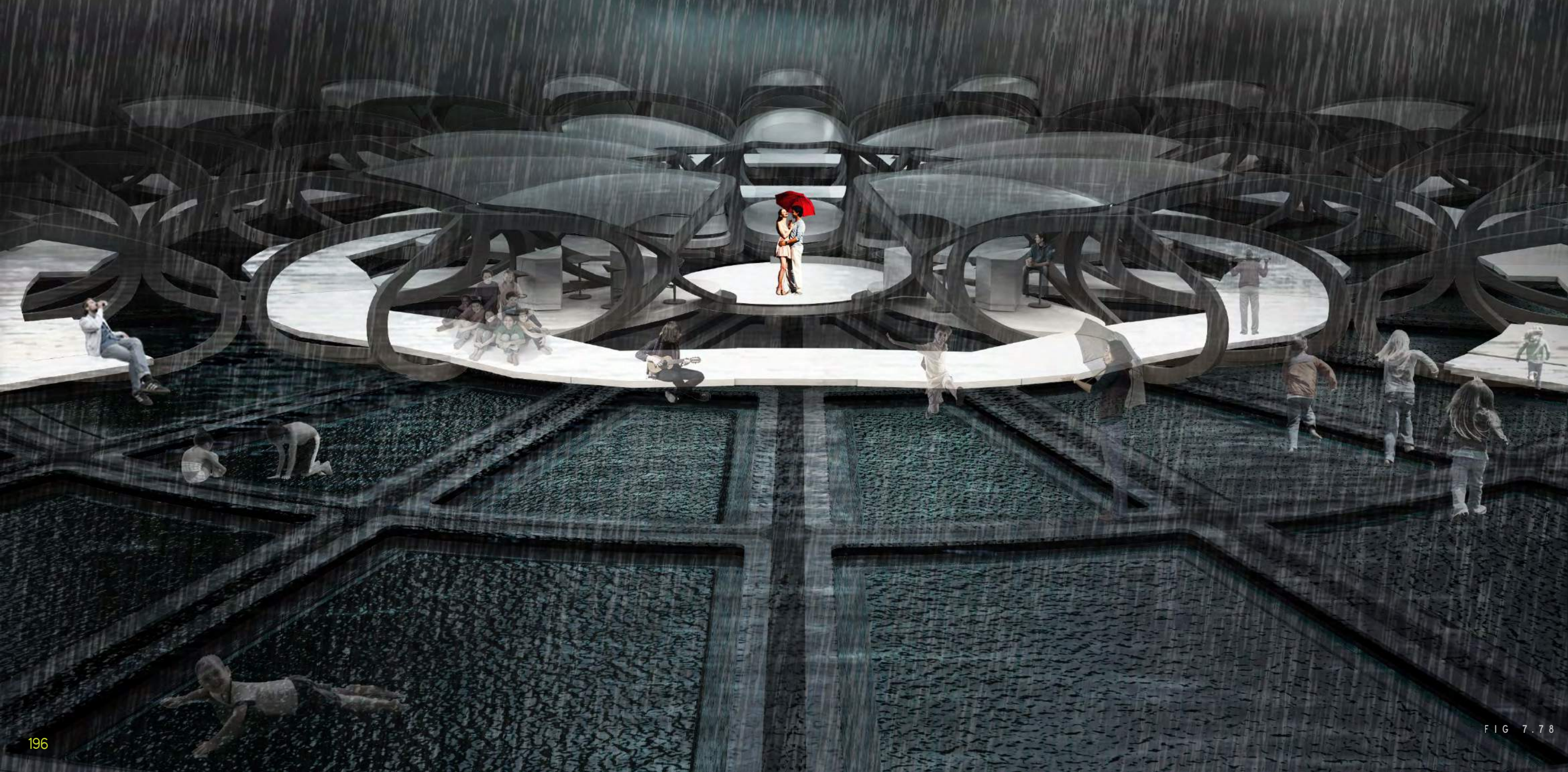

FIG 7.75





FIG 7.77



C O N C L U S I O N

Temporary architecture has the ability and power to help with the construction of our urban existing and proposed plans. Not only does temporary reactivate space as we have seen at an urban scale, but it also has the potential for impact at every scale. The study of this thesis has demonstrated that temporary uses and activities are successful to be considered in every design because they are one of the manifestations of personal and community activism. Such expressions of this vary from holiday celebrations, to urban markets, sports and other cultural parties. They have a common thread occurring and it is that they happen largely outside the control of business or government. The empowerment that this activities provoke can reinvigorate political systems, social structures and local economies.

The energy that it brings can not only add delight to the urban landscape through its fleeting manifestations, but can reinvent the city with a creativity that is often lacking in the city authorities themselves. It is important to keep considering that our society keeps evolving and as designers it is our obligation to help promote further development through innovative ways of architecture.





EPHEMERAL INTERSECTION

Ephemeral architecture as a tool for reactivating the public realm and increase cultural, economic, & urban growth

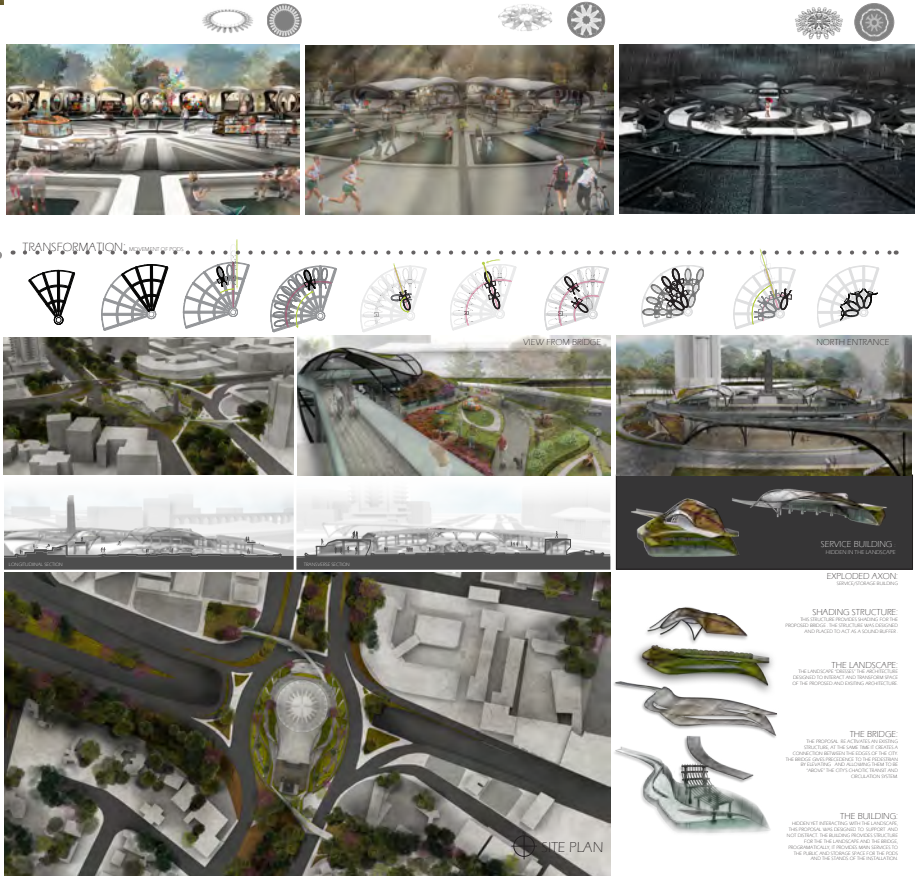
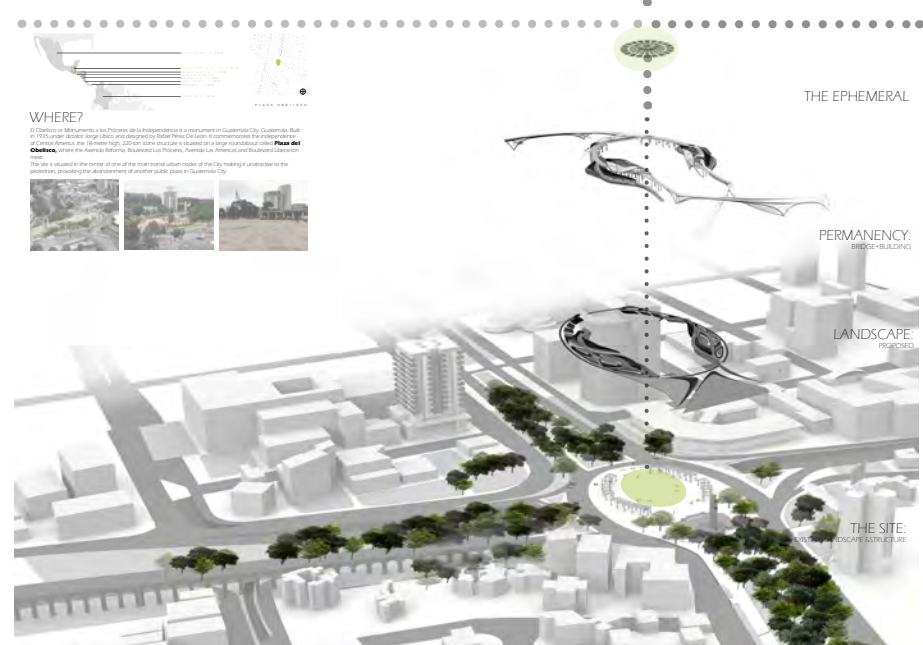
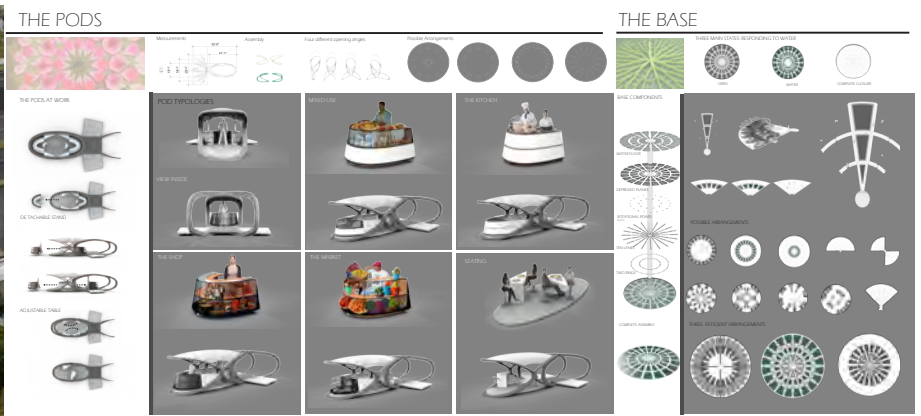

FINAL BOARDS

Designing for security

Felicella, Elizabeth, et al. Designing for security. New York: Art Commission of the City of New York, 2002. Print.

Green Architecture

Wines, James. Green Architecture. New York, Koln: Taschen, 2000. Print.

XS: small structures, green architecture

Richardson, Phyllis. XS: small structures, green architecture. New York, NY: Universe, 2007. Print.

Green architecture: a guide to sustainable design

Richardson, Phyllis. XS: small structures, green architecture. New York, NY: Universe, 2007. Print.

Architecture and urbanization of colonial Central America

Markman, Sidney David. Architecture and urbanization of colonial Central America. Tempe: ASU Center for Latin American Studies, Arizona State University, 1993. Print.

Architecture: Nature

Jodidio, Philip. Architecture: nature. Munich, New York: Prestel, 2006. Print.

Bio- architecture

Aguilar Senosiain, Javier. Bio-architecture. Oxford, Burlington, MA: Architectural Press, 2003. Print.

Installation art

Wang, Shaoqiang. Installation art. Corte Madera: Gingko Press, 2010. Print.

Installation art now

Gingko Press. Installation art now. Berkeley, CA: Gingko Press, 2013. Print.

Fair design: architecture for exhibition

Kramer, Sibylle. Fair design: architecture for exhibition. Berlin: Braun, 2009. Print.

Temporary Structures

Kawamata, Tadashi. Temporary Structures. Vol. 97. Kyoto: Kyoto Shoin, 1991. Print.

Caring for the past: preserving, rehabilitating and restoring historic buildings

United States. National Park Service. Technical Preservation. preserving, rehabilitating and restoring historic buildings. Washington, D.C: Us Dept. of the interior, National Park Service, 2001. Print.

Recycling architecture

DAAI: Desing and applied Arts Index. "Recylcing architecture." Domus (2011): 98. Print.

Recycling spaces: curating urban evolution: the work of Martha Schwartz Partners

Schwartz, Martha, and Emily Waugh. Recycling spaces: curating urban evolution: the work of Martha Schwartz Partners. Novato, CA: ORO Editions, 2011. Print.

Foundations of landscape architecture : integrating form and space using the language of site design

Booth, Norman K. Foundations of Landscape architecture. Hoboken, NJ: Wiley, 2012. Print.

Star landscape architecture: the stars of landscape and land art

Mola, Francesc Zamora, and Julio Fajardo. Star landscape architecture. Barcelona, Spain: Loft, 2010. Print.

Relating architecture to landscape

Birksted, Jan. Relating architecture to landscape. New York, London: E & FN Spon, 1999. Print.

On site: landscape architecture Europe

Landscape Architectue Europe. On site: landscape architecture Europe. Basel, Boston: Brikhauser, 2009. Print.

Japan. Towards totalscape

Kira, Moriko, and Mariko Tereda. Japan, Toward totalscape. Rotterdam, New York, NY: NAI Publishers, 2000. Print.

Urban landscapes: international perspectives

Whitehand, J.W., and P.J Larkham. Urban Landscapes. London: np., 1992. Print. Routledge geography and environment series.

Urban landscape design

Flannery, John A., and Karen M. Smith. Urban Landscape design. Kempe, Germany: TeNeues, 2008. Print.

Urban future manifestos

Meyer, Kimberli. Urban future manifestos. Ostfildern, Holly: Hat je/Cantz, 2010. Print.

Urban Spaces

Dixon, John. Urban spaces. New York: Visual Reference Publications, 1999. Print.

Urban development: The logic of making plans

Hopkins, Lewis D. Urban development. Washington: Island Press, 2001. Print.

Land Art

Lailach, Michael, and Uta Grosenick. Land art. Koln: Taschen, 2007. Print.

Articles

Landscape architecture in Central America and the Caribbean

Jankilevich, Carlos. "Landscape architecture in Central America and the Caribbean." Topos: the international review of landscape architecture and urban design 65th ser. (2008): 93-97.

Architecture and security

Avery Index to Architectural Periodicals. "Architecture and security." Leading architecture and design (2007): 59-64. Print.

Land art: city architecture

Decker, Thomas. "Land art: city architecture." Issues in Architecture, Art and Design 6th ser. 1 (1999): 34-51.

Online

Pasos y Pedales

Pasos y Pedales. Municipalidad de Guatemala, n.d. Web. 13 Oct. 2013. <<http://pasosypedales.com/>>.

Guatemala 2013 Crime and Safety Report

OSAC. U.S. Department of State, n.d. Web. 12 Sept. 2013. <<https://www.osac.gov/pages/ContentReportDetails.aspx?cid=13878>>.

